



**NOTES:**  
 THIS PLAN WAS PREPARED AS A PROPOSED SUBDIVISION TO ACCOMPANY A DEVELOPMENT APPLICATION TO WINGECARRIBEE SHIRE COUNCIL AND SHOULD NOT BE USED FOR ANY OTHER PURPOSE. THE DIMENSIONS AREAS AND TOTAL NUMBER OF LOTS SHOWN HEREON ARE SUBJECT TO FIELD SURVEY AND ALSO TO THE REQUIREMENTS OF COUNCIL AND ANY OTHER AUTHORITY WHICH MAY HAVE REQUIREMENTS UNDER ANY RELEVANT LEGISLATION. IN PARTICULAR, NO RELIANCE SHOULD BE PLACED ON THE INFORMATION ON THIS PLAN FOR ANY FINANCIAL DEALINGS INVOLVING THE LAND. THE LAND SHOWN HEREON MAY BE SUBJECT TO CURRENT OR PROPOSED EASEMENTS AND/OR RESTRICTIONS ON THE USE OF LAND, DRAINAGE EASEMENTS, SEWER LINES AND OTHER UNDERGROUND SERVICES MAY BE CONSTRUCTED UPON ANY OF THE LOTS, THIS BEING SUBJECT TO ENGINEERING DESIGN, AND OR REQUIREMENTS OF THE COUNCIL AND OTHER UTILITY PROVIDERS. THIS NOTE IS AN INTEGRAL PART OF THIS PLAN.

revision	revision details	date	drawn
A	Initial Issue	01/07/19	JC
B	Residual Lot Amendments	09/07/19	JC
C	Reserve & Residual Lot Amendments	10/07/19	JC
D	Lot No.s Amended	03/09/19	JC
E	Lot Amendments & Renumber	29/10/19	JC
F	Lot Amendments & Renumber	05/11/19	JC
G	Lot Amendments	10/03/20	JC
H	Road Labeling	06/10/20	JC

Civil Development Solutions  
 This document was prepared from lot layouts provided by Arterra and Cardno. Internal lot layout taken from Arterra file: 190703-MossVale-Stage1LandscapeDA.dwg External boundaries taken from Cardno Autocad file: 82018221 boundary final 2019.05.29.dwg



WINGECARRIBEE SHIRE COUNCIL DA: -  
**PROPOSED SUBDIVISION OF LOT3 DP706194 & 12 DP866036 YARRAWA ROAD, MOSS VALE**  
 client: AOYUAN PTY LTD

**OVERALL SITE PLAN STAGE 1**

designed: -	A1 sheet	revision H
drawn: J.C.	Job Drawing Number	
checked: R.A.	<b>1429</b>	
datum: -	<b>DA02</b>	
date: 08/01/19	sheet 1	sheets 2

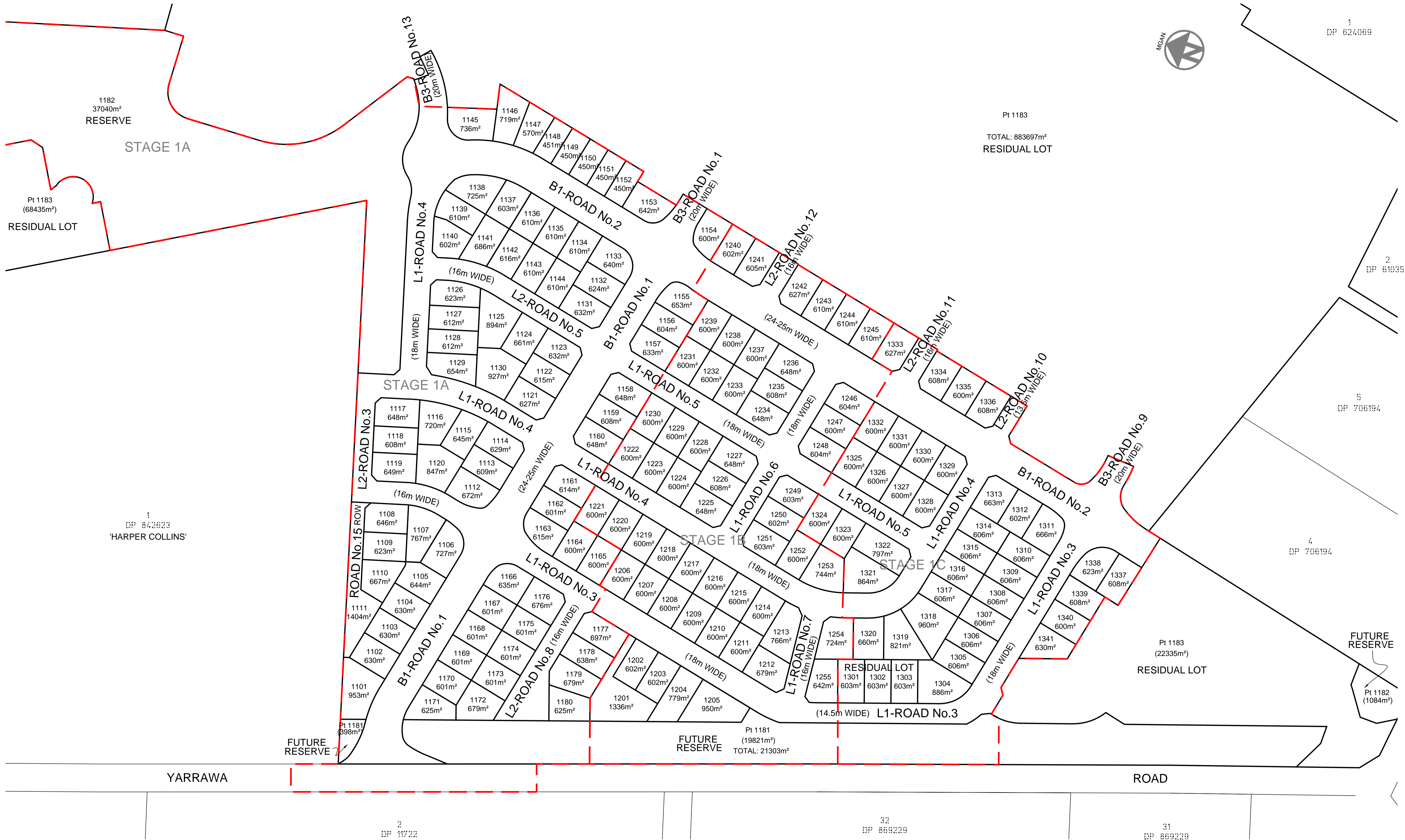
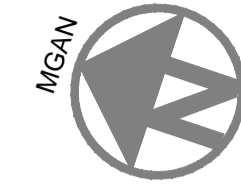

**NOTES:**  
 THIS PLAN WAS PREPARED AS A PROPOSED SUBDIVISION TO ACCOMPANY A DEVELOPMENT APPLICATION TO WINGECARRIBEE SHIRE COUNCIL AND SHOULD NOT BE USED FOR ANY OTHER PURPOSE. THE DIMENSIONS AREAS AND TOTAL NUMBER OF LOTS SHOWN HEREON ARE SUBJECT TO FIELD SURVEY AND ALSO TO THE REQUIREMENTS OF COUNCIL AND ANY OTHER AUTHORITY WHICH MAY HAVE REQUIREMENTS UNDER ANY RELEVANT LEGISLATION. IN PARTICULAR, NO RELIANCE SHOULD BE PLACED ON THE INFORMATION ON THIS PLAN FOR ANY FINANCIAL DEALINGS INVOLVING THE LAND. THE LAND SHOWN HEREON MAY BE SUBJECT TO CURRENT OR PROPOSED EASEMENTS AND/OR RESTRICTIONS ON THE USE OF LAND, DRAINAGE EASEMENTS, SEWER LINES AND OTHER UNDERGROUND SERVICES MAY BE CONSTRUCTED UPON ANY OF THE LOTS, THIS BEING SUBJECT TO ENGINEERING DESIGN, AND OR REQUIREMENTS OF THE COUNCIL AND OTHER UTILITY PROVIDERS. THIS NOTE IS AN INTEGRAL PART OF THIS PLAN.

revision	revision details	date	drawn
A	Initial Issue	01/07/19	JC
B	Residual Lot Amendments	09/07/19	JC
C	Reserve & Residual Lot Amendments	10/07/19	JC
D	Lot No.s Amended	03/09/19	JC
E	Lot Amendments & Renumber	29/10/19	JC
F	Lot Amendments & Renumber	05/11/19	JC
G	Lot Amendments	10/03/20	JC
H	Road Labeling	06/10/20	JC

Civil Development Solutions  
 This document was prepared from lot layouts provided by Anterra and Cardno.  
 Internal lot layout taken from Anterra file: 190703-MossVale-Stage1LandscapeDA.dwg  
 External boundaries taken from Cardno Autocad file: 82018221 boundary final 2019.05.29.dwg



WINGECARRIBEE SHIRE COUNCIL DA: -  
**PROPOSED SUBDIVISION OF LOT3 DP706194 & 12 DP866036 YARRAWA ROAD, MOSS VALE**  
 client: AOYUAN PTY LTD

**PLAN OF PROPOSED SUBDIVISION STAGE 1**

designed: -	A1 sheet	revision H
drawn: J.C.	Job Drawing Number	
checked: R.A.	<b>1429 DA02</b>	
date: 08/01/19	sheet 2	sheets 2